

Reflector (1)

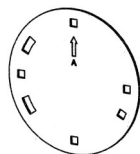

Skew Plate (1)

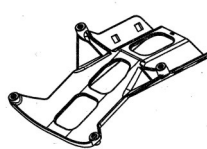

TRIA Mounting Bracket (1)

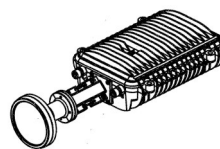

TRIA Assembly (1)



Boom Arm (2)

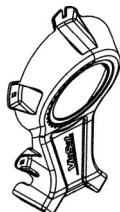

Antenna Back Bracket (1)

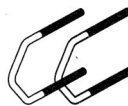

U-shaped Pole Clamp Bolt (2)

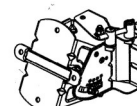

Elevation Bracket (1)



M8 x 45 mm carriage bolt (4)



M5 x 25 mm hex head bolt (1)



M5 pozi-pan head screw (4)

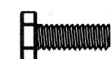

M8 UNC x 20 mm hex head bolt (4)

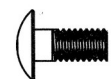

M8 UNC x 20 mm carriage bolt (9)



M8 serrated flange nut (9)



F-connector (2)

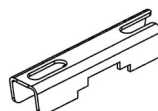

Pole Clamp Bar (1)



Grounding Wire (1)



M8 UNC washer (12)



M8 spring washer (8)



M5 hex nut (1)



M5 tooth lock washer (1)



M5 spring washer (4)



M8 nut (8)



Coaxial Cable (1)



toowaySAT Surfbeam Modem (1)

Installation of the Hardware (Satellite Dish):

1. Please assemble the Sat Dish as shown (steps 1-9).

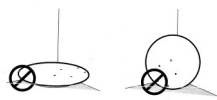
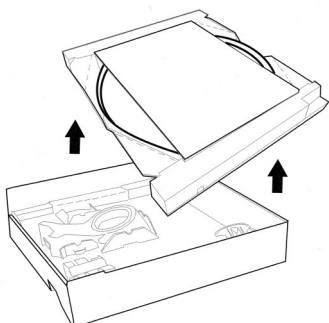

1

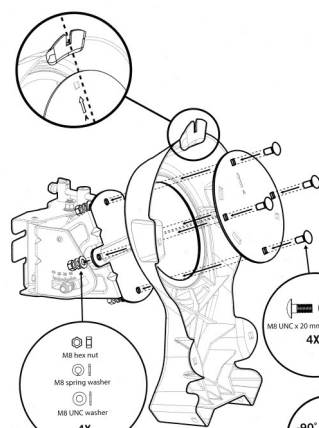

2

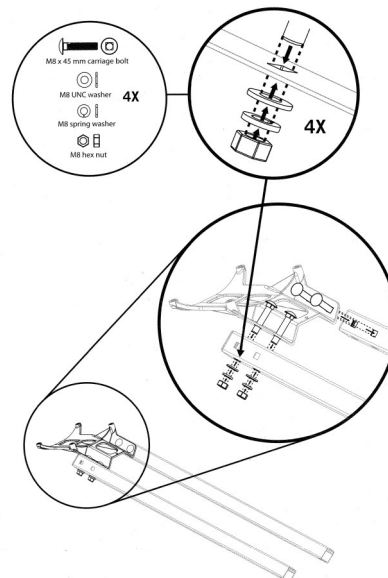

3

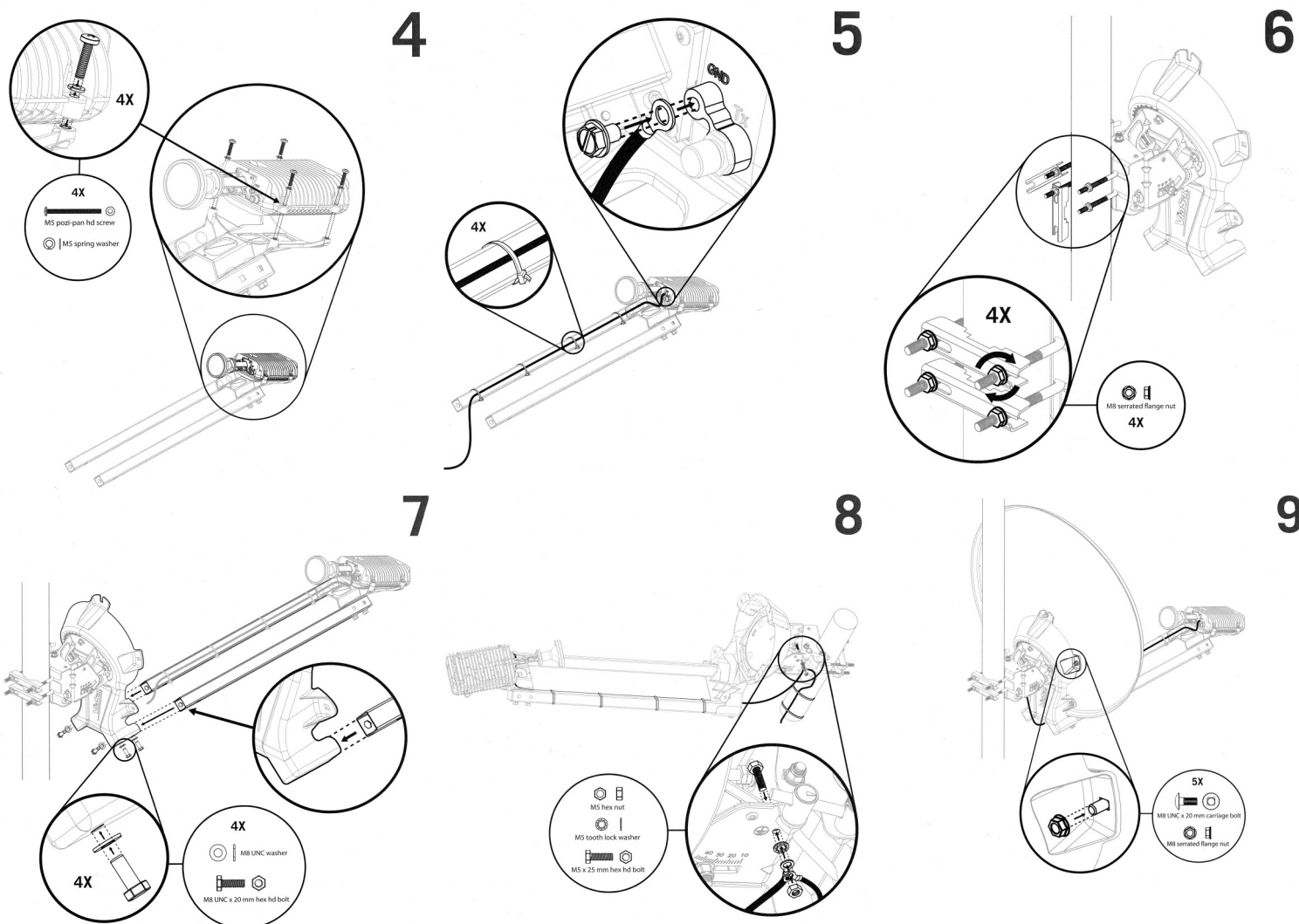

2. Please visit this Website www.kasat-finder.com and <http://www.satsig.net/tooway/satellite-dish-pointing-ka-sat-tooway-europe.htm> to point the toowaySat Dish to the right Direction and to choose your valid Spot Beam.

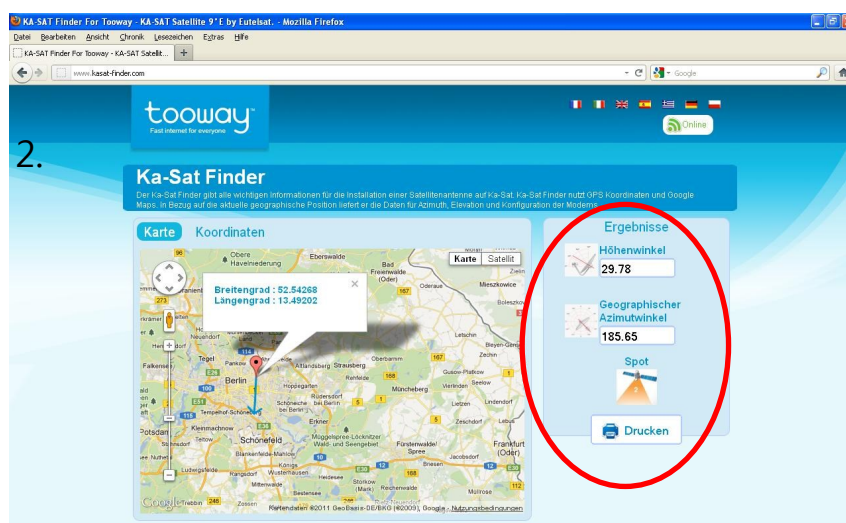

3. In order to simplify the installation, you should set now the elevation angle at the Sat Dish to have at first a rough Elevation Angle adjustment.

4. Please install the Sat Dish on a stable Mast Pole (recommended diameter 60 mm) with a free view to southern direction.

5. Please install the supplied F-Connector on the delivered coaxial cable and connect the toowaySat Modem to the Tx port on the Tria (LNB). (The Rx port of the Tria is not required and is not used for the non Professional Modem). The F-connector must be plugged and not screwed on. **PLEASE NOTE: THE COAXIAL CABLE SHOULD BE IDEALLY 15 METER! (max. cable length 50 meter).**

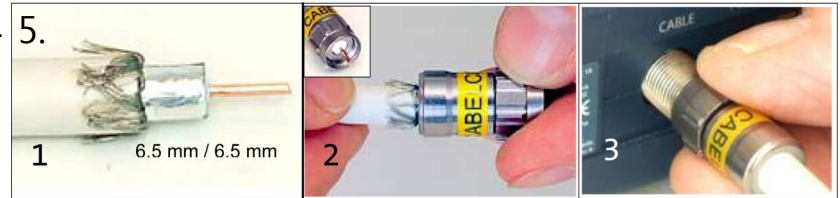

6. Please connect the Satellite Modem and your computer by using the supplied network cable (blue/ yellow) and connect the satellite modem to the power supply. Please note that the network card has not assigned a static IP address on your computer settings.

7. Please open any Internet Browser (Preferred Firefox) on your computer and type in this address: 192.168.100.1/install You are now in the installation process of the toowaySAT System. Please choose the appropriate location for your Spot Beam color from item 2 and then click on next at the bottom on "→".

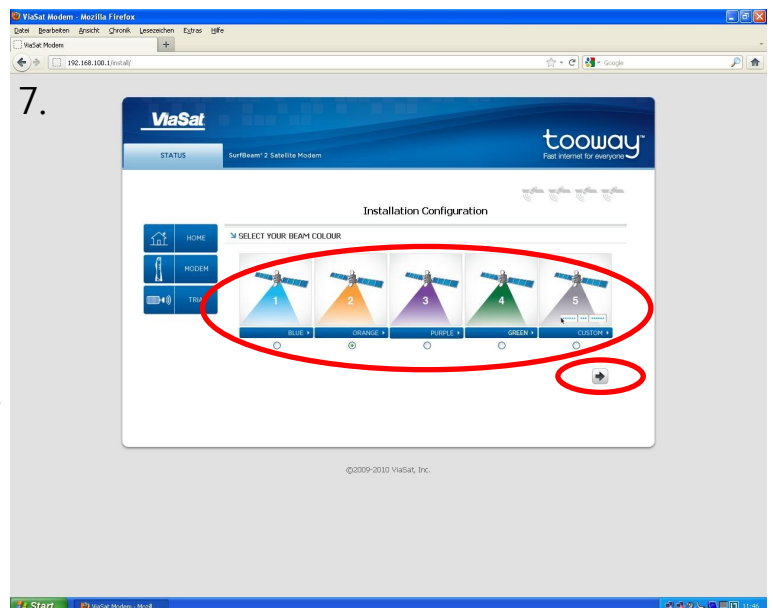

8. Please now aim the toowaySAT system based on the beep coming from the Tria. If a continuous beep appears then the system is first stage aligned, lightly tighten bolts. Cover the feedhorn for 7 beeps – then repeat fine adjustment for final optimal alignment. When the constant beep returns, and can now be fully tightened- make sure when you tighten the antenna, the alignment is not changing!

9. After fixing the Sat Dish, check the signal strength shown on the computer Display. Both signal strength must be higher than 9 dB. Please click at the bottom right on "→".

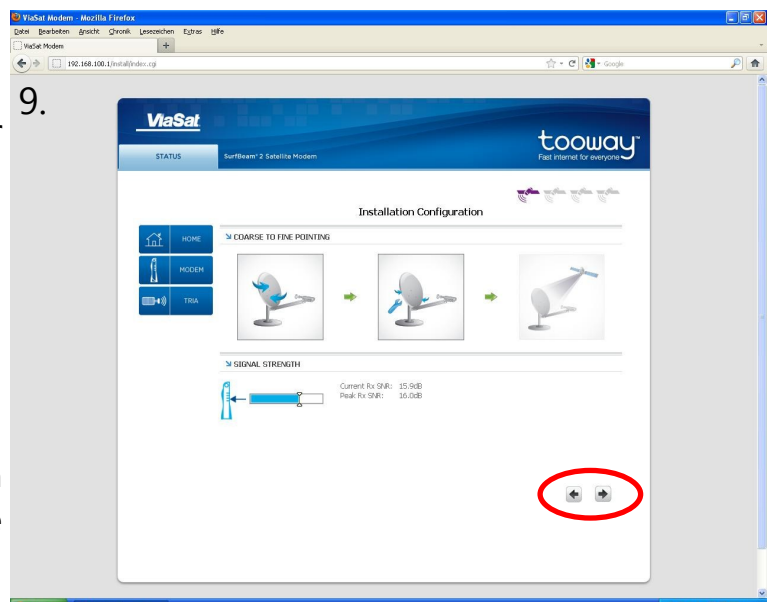

10. You are entering now to the Home page of the Sat Modem "Basic Status". Please click on "Modem" to get the initial Activation steps and to monitor the settings of the Sat Modem.

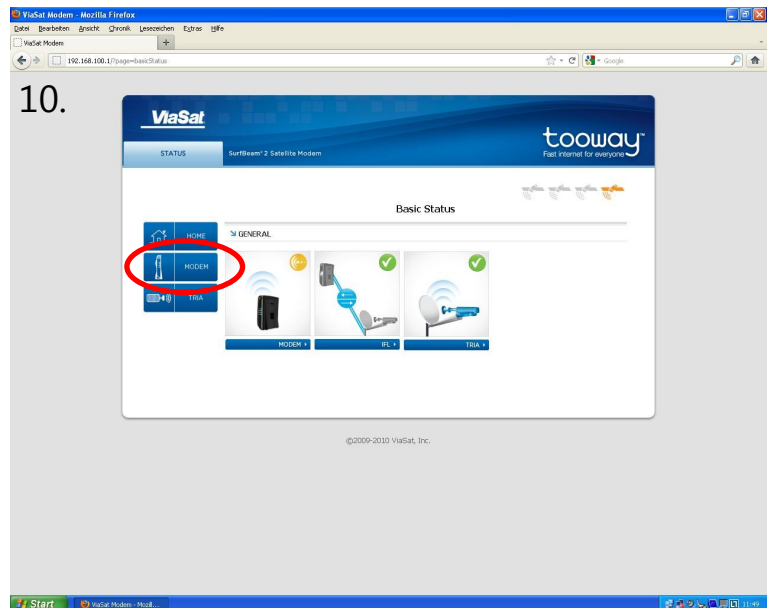

11. The Connection is completed when all four circular icons/ symbols are green and the status "online" will appear (this may take in exceptional cases up to one hour).

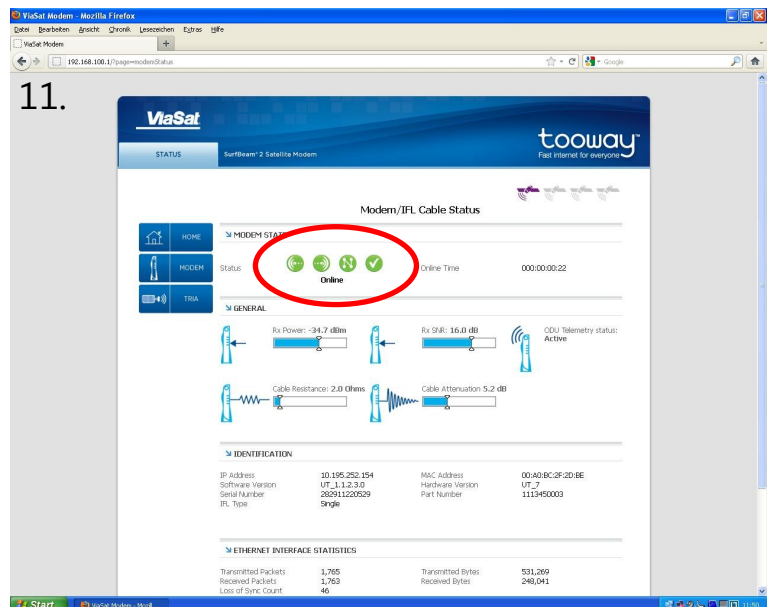

12. After all the circle icons/ symbols are green, please wait 5 minutes and then call any web page (e.g. www.google.com) on the Internet browser. You will be redirected to the „Self Activation“ page. To start the activation process please click on „here“.

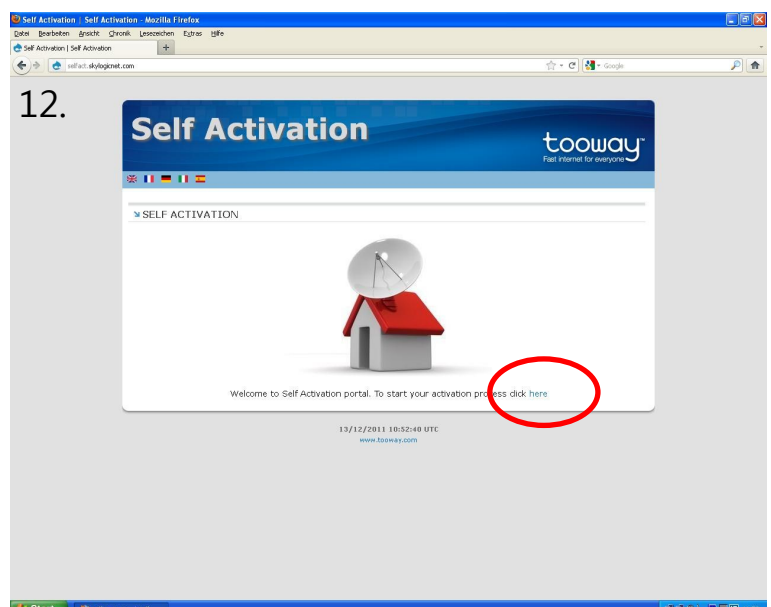

13. You will get now once again the signal strength condition of the toowaySAT system displayed. Please make sure that the received and transmit signal is always higher than 9 dB to guarantee that the service is operating smoothly. The activation Process and the Service want operate with and value lower than 9 dB!

Please click now on "continue".

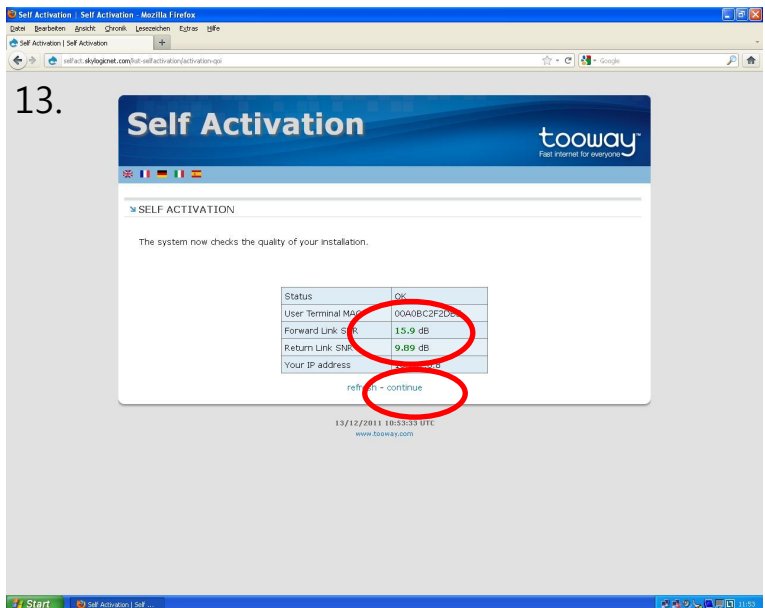

14. Please enter the toowaySat activation key you should got by eMail or Postal Mail and click on „Save“. Your key will now checked online.

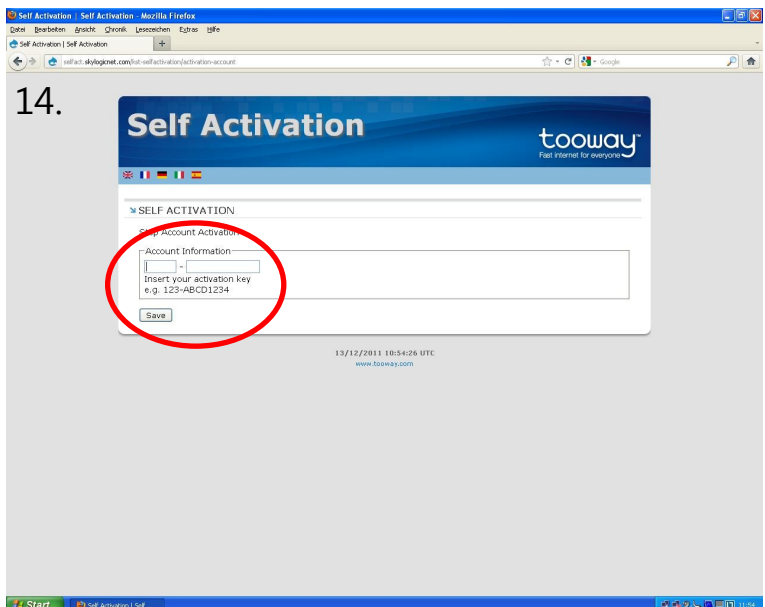

15. Your key has been accepted, your toowaySAT System is registered and activated. Click below in the middle on "Reboot". The toowaySAT Modem will do a automatic restart to finalize the activation process.

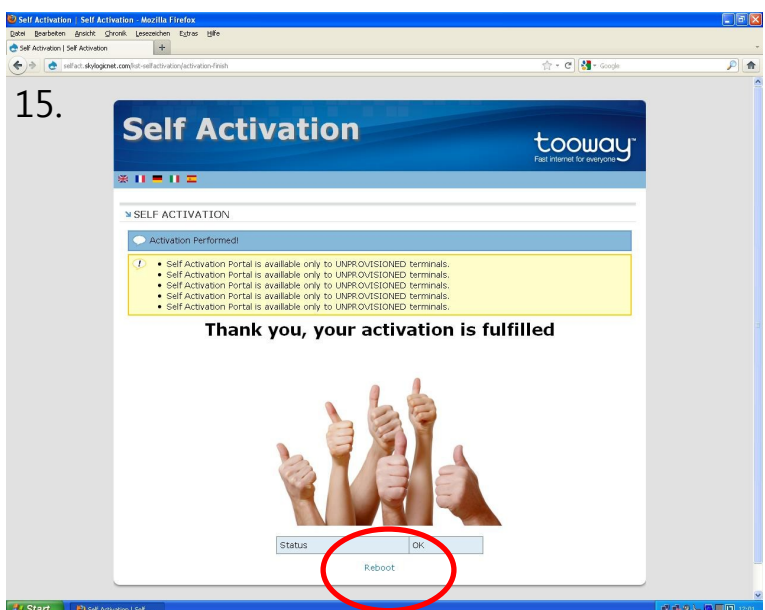

16. After the toowaySAT Modem has re-booted, it takes about 5 minutes until the Modem has registered again on the satellite.

17. Now your toowaySAT Satellite System is ready to surf!
If you want to check your modem status at any time, you will find it under this IP Address: **192.168.100.1** on the diagnostic side of the modem.



On our Weblink www.toowaysat.com/faq.php you will also find a complete installation video.

If you will need support by the installation-process, please do not hesitate to contact our Support Team.

Monday - Friday

09:00 - 18:00

Hotline: (+49) 01803-866 929

for 9 Cents/min within german fixed telefonline or max. 42 Cents/min from a german Mobile line.

eMail: support@toowaysat.com